

DIVISIONS of SUBDIVISION  
 GRAND VIEW PLACE  
 Section 2-Twp 44 R.12.  
 Cole Co. Mo.  
 October 16, 1923  
 Scale of 1" = 100'  
 James Hines  
 Surveyor

BINDER PARK

TEN

MILE DRIVE

1/2 27 South Hill

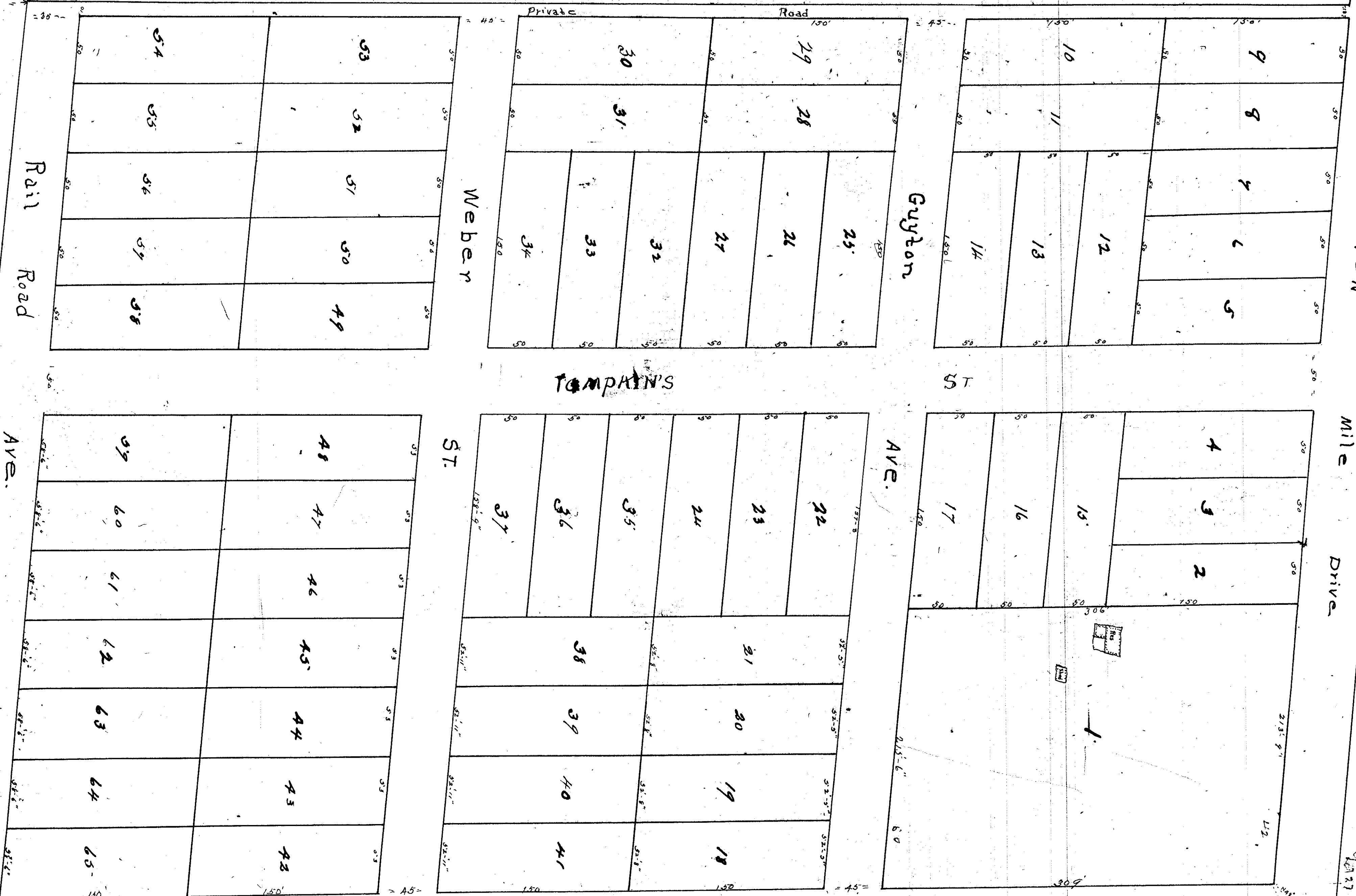
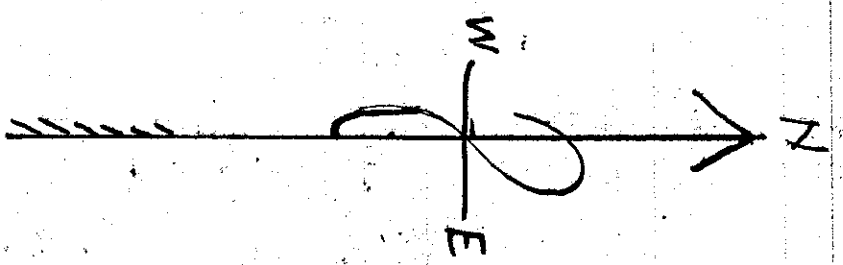

please that  
 new township  
 of all the  
 whole part  
 by Mr.  
 in 2 township  
 section of  
 ave. in section  
 runs on the  
 w. side  
 have paid  
 a fee  
 that on the  
 east side  
 we have  
 cleared this  
 township  
 to before  
 when 1923  
 & Binder  
 Mary Fuller  
 1/6 the day  
 30' each  
 11.  
 out  
 under

Know we all more by these  
we people hunting land by  
the land being the person  
to give land to New Place  
of the state east of the  
of 144 Range 12 West, 9th  
included in the boundaries of  
the Division of Hand River  
2 Township, 144 Range 12, 9th  
range East, called the  
of Hand River Place.

It is hereby certified that we  
all the State use and  
against the said parties  
whom it is the number of  
same are fully and truly  
in witness whereof  
I set my hand and  
5th day of December, 1922

Subscribed and sworn  
me this 5th day of Decem  
E. J. [unclear]

Seal  
My Commission expires  
October 21, 1925

Filed for record to  
of November 1923, at  
and 25 minutes. P. F. [unclear]

by Marie Brown  
Deputy