

# "MONTICELLO ACRES - SECTION FOUR"

5.22 TOTAL ACRES  
ZONED RA-2

PROPERTY DESCRIPTION

Part of the Southeast Quarter of Section 4, Township 44 North, Range 12 West, in the City of Jefferson, Cole County, Missouri, more particularly described as follows:

From the southeast corner of said Section 4; thence S86°32'02"W, along the Section Line, 1787.79 feet to the southwest corner of the tract described by deed of record in Book 287, Page 319, Cole County Recorder's Office; thence N03°45'20"W, along the west line of said tract, 1654.23 feet to a point on the northerly line of West Truman Boulevard; thence Easterly, along the northerly line of said West Truman Boulevard, on a curve to the left, having a radius of 2824.79 feet, an arc distance of 674.76 feet, (the chord of said curve being N76°37'44"E, 673.16 feet); to the POINT OF BEGINNING for this description; thence N20°49'22"W, 25.34 feet; thence Northerly, on a curve to the right, having a radius of 139.16 feet, an arc distance of 97.76 feet, (the chord of said curve being N00°41'55"W, 95.76 feet); thence N19°25'33"E, 128.46 feet; thence Northerly, on a curve to the left, having a radius of 340.05 feet, an arc distance of 63.28 feet, (the chord of said curve being N14°05'41"E, 63.19 feet); thence S79°38'44"W, 2.10 feet to the southeast corner of a tract of land described by deed of record in Book 174, Page 121, Cole County Recorder's Office; thence N03°37'46"W, along the east line of said tract, 418.95 feet to the northeast corner thereof, being also a point on the southerly line of North Ten Mile Drive; thence N78°53'50"E, along the southerly line of said North Ten Mile Drive, 325.06 feet to the northwest corner of a tract of land described by deed of record in Book 93, Page 506, Cole County Recorder's Office; thence S04°07'29"E, along the west line of said tract, and along the west line of another tract described by deed of record in Book 108, Page 561, Cole County Recorder's Office, 811.08 feet to a point on the northerly line of West Truman Boulevard; thence Westerly, along the northerly line of West Truman Boulevard, the following courses: S62°55'16"W, 81.37 feet; thence Westerly on a curve to the right, having a radius of 2824.79 feet, an arc distance of 338.43 feet, (the chord of said curve being S66°21'12"W, 338.23 feet), to the POINT OF BEGINNING, containing 5.22 acres.

SURVEYOR'S CERTIFICATE

This is to certify that at the request of Elmer and Lorene B. Goldammer, a survey was made, under my personal direction, regarding the above described property, and that the results of said survey are represented correctly on this plat and that said survey was executed in accordance with the current Minimum Standards for Property Boundary Surveys 10 CSR 30-2.010.

In Witness whereof I have hereunto set my seal and signature this 11 day of JANUARY, 1988.

*Louis N. Vetter*  
LOUIS N. VETTER, Mo. R.L.S. #1166

OWNER'S CERTIFICATE

Know all men by these presents that we, the undersigned, being the owners of the tract of land described in the foregoing Property Description, have caused said tract to be surveyed and subdivided into a Lot, Street and Reserved Tract, and on this plat the lot number and size thereof is fully and truly set forth, and the undersigned do hereby dedicate to the public, for public use forever, the street and all easements not presently of record as shown on this plat which shall be known as "MONTICELLO ACRES - SECTION FOUR".

All taxes due and payable against said property have been paid in full.

In Witness whereof, the undersigned owners of said tract have hereunto set their hand and seals on this 11 day of January, 1988.

*Elmer F. Goldammer* *Lorene B. Goldammer*  
Elmer F. Goldammer Lorene B. Goldammer

STATE OF MISSOURI )  
COUNTY OF COLE ) ss

On this 11 day of January, 1988, before me personally did appear the above signed property owners who executed the foregoing instrument and acknowledged the same to be their free act and deed.

In Witness whereof, I have set my hand and affixed my seal this 11 day of January, 1988.

My Commission Expires: 12/30/91 *Carole Cardwell*  
Carole Cardwell, Notary Public

I, the City Clerk, of the City of Jefferson, County of Cole, State of Missouri, hereby certify that this plat was approved by the Mayor of the City of Jefferson, Missouri, by Ordinance No. 10534.

Approved this 15 day of January, 1988.

*Louise Gardner* *Brenda M. Curtin*  
Louise Gardner, Mayor Brenda M. Curtin, City Clerk  
*Robert M. Bates* *Thomas H. Benton*  
Robert M. Bates, Director of Public Works Thomas H. Benton, Director of Planning

Document No. 638  
STATE OF MISSOURI )  
COUNTY OF COLE ) ss  
Filed for record 1st day of February, 1988  
at 1 O'clock and 30 Minutes A.M.,  
recorded in Book 11, Page 374.  
DAVID R. NEMSAM, Recorder

<b>CENTRAL MISSOURI PROFESSIONAL SERVICES, INC.</b> ENGINEERING AND SURVEYING TEST DRILLING 2500 EAST MC CARTY JEFFERSON CITY, MISSOURI 66101			
TITLE "MONTICELLO ACRES - SECTION FOUR"			
FOR ELMER GOLDAMMER <b>COMPLETED</b>			
DATE Aug. 1987	BOOK NO.	SCALE 1"=50'	DRN. BY DGS
REVISION DATE	CKD. BY	SHEET 1 OF 1	JOB NO. 77-24

SUB331.03 **SUB #331-IV**

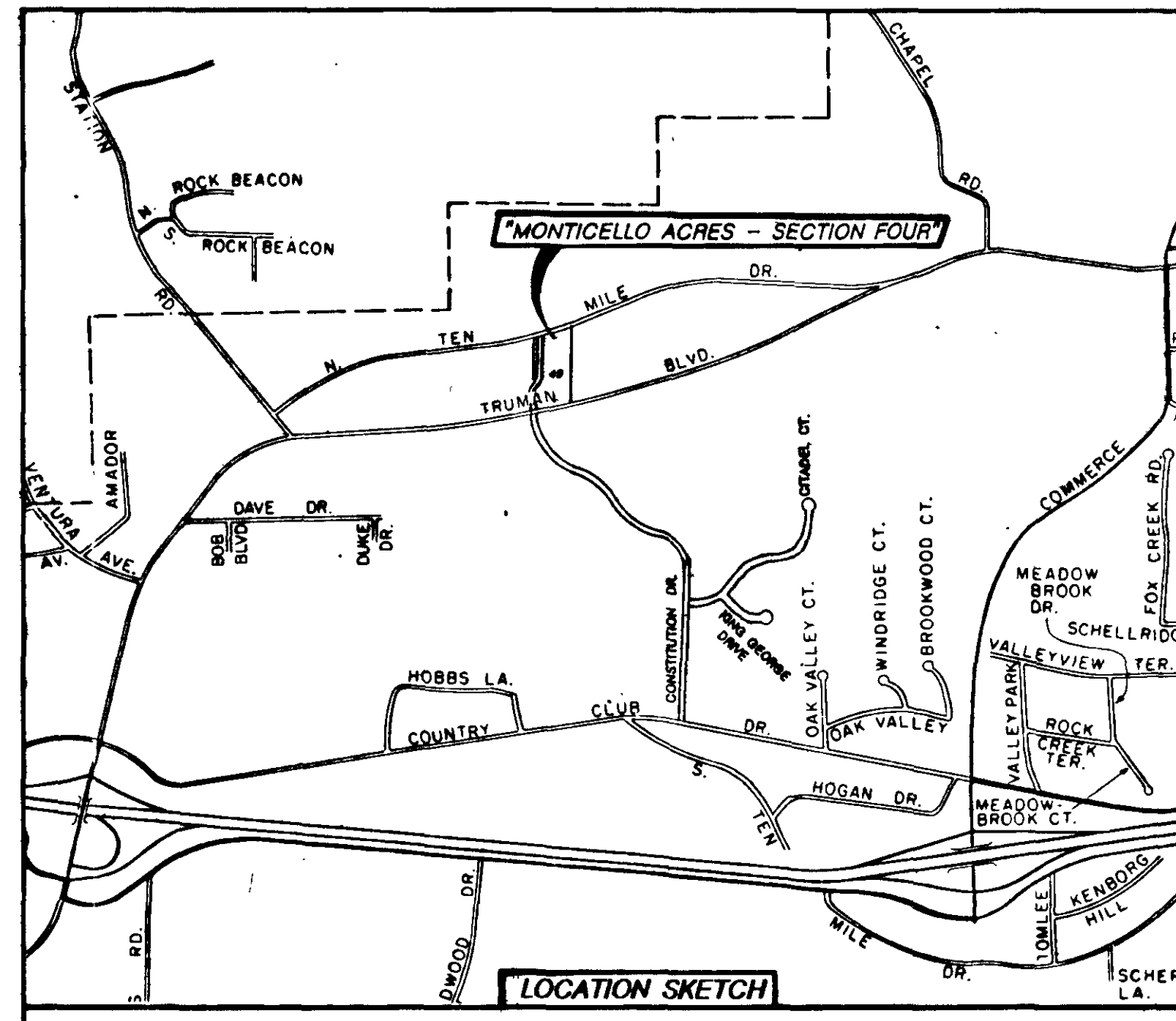

JOHN F. & MARY L. NIENHUESER  
Book 174, Page 121

RESERVED TRACT "A"  
2630.95 Sq. Ft.

SE 1/4, SEC. 4, T44N, R12W

MID-MISSOURI MEDICAL FOUNDATION, INC.

WEST TRUMAN BOULEVARD

ELMER F. & LORENE B. GOLDAMMER  
Book 287, Page 319

ELMER F. & LORENE B. GOLDAMMER  
Book 287, Page 319

SE Corner Section 4 T44N, R12W  
1787.79' S06°32'02"W Section Line

BEARINGS BASED ON DEED OF RECORD IN BOOK 287, PAGE 319, COLE COUNTY RECORDER'S OFFICE.

JOHN H. & PAULINE HAGER  
Book 108, Page 561

Book 93, Page 506

NORTH TEN MILE DRIVE

CONSTITUTION DRIVE

49  
4.21 Acres

