

REPLAT OF LOTS 14 AND 15,
RENN'S ADDITION, AS RECORDED IN
PLAT BOOK 2, PAGE 5

PRESENTLY ZONED: RS-4
TOTAL AREA: 22,152 SQ. FT.

PROPERTY BOUNDARY DESCRIPTION
All of LOTS 14 AND 15, in Block Number 23, of RENNS ADDITION to the City of Jefferson,
County of Cole, Missouri, as recorded in Plat Book 2, page 5, Cole County Recorder's Office.

OWNER'S CERTIFICATE
Know all men by these presents that We, the undersigned owners of the tract of land described in the foregoing Property Description, have caused said tract to be surveyed and resubdivided into lots and on this plat the numbers of the lots and the sizes thereof are fully and truly set forth, and the undersigned do hereby dedicate to the Public for Public use forever all Right-of-ways and Easements (not presently of record) as shown on this plat and said plat shall be known as "REPLAT OF LOTS 14 AND 15 OF RENNS ADDITION".

All taxes due and payable against said property have been paid in full.
In Witness whereof, the undersigned owners of said tract have hereunto set their hands and seals this 5th day of July, 2006.

BRAUN & RACKERS, L.L.C., A MISSOURI LIMITED LIABILITY COMPANY.

Gary W. Braun
GARY W. BRAUN, MEMBER
Chad M. Rackers
CHAD M. RACKERS, MEMBER

STATE OF MISSOURI } ss
COUNTY OF COLE }

On this 5th day of July, 2006, before me personally did appear Chad Rackers and Gary Braun, to me known to be the persons described in and who executed the foregoing instrument and acknowledged that they executed the same as their free act and deed.

In Witness whereof, I have set my hand and affixed my seal this 5th day of July, 2006.

My Commission Expires: 12/28/07

Louise Krcmar
Notary Public, Notary Seal
STATE OF MISSOURI
County of Callaway
My Commission Expires 12/28/2007

LOUISE KRUMAR
Notary Public, Notary Seal
STATE OF MISSOURI
County of Callaway
My Commission Expires 12/28/2007

SURVEYOR'S CERTIFICATE
This is to certify that at the request of Chad Rackers, a Property Boundary Survey and Subdivision was made under my personal direction regarding the property shown on this plat and that the results are represented correctly. This survey was performed in accordance with the current requirements of the standards for an Urban Property Boundary Survey as adopted by the Missouri Board for Architects, Professional Engineers and Land Surveyors.

In Witness whereof, I have hereunto set my seal and signature this 5th day of July, 2006.



07-05-2006
J. Brian Rockwell, MO R.L.S. #2524

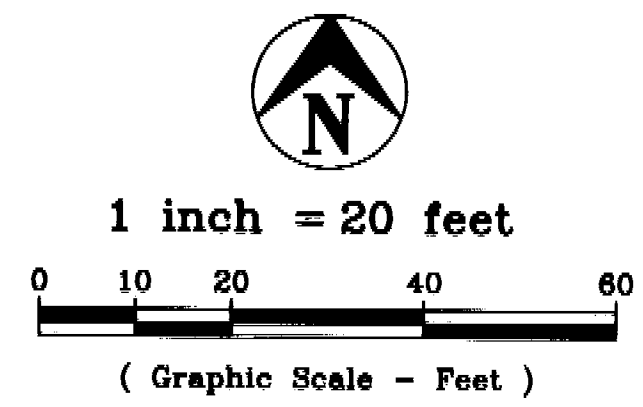

BEARING BASE: Renn's Addition as recorded in Plat Book 2, page 5, Cole County Recorder's Office.

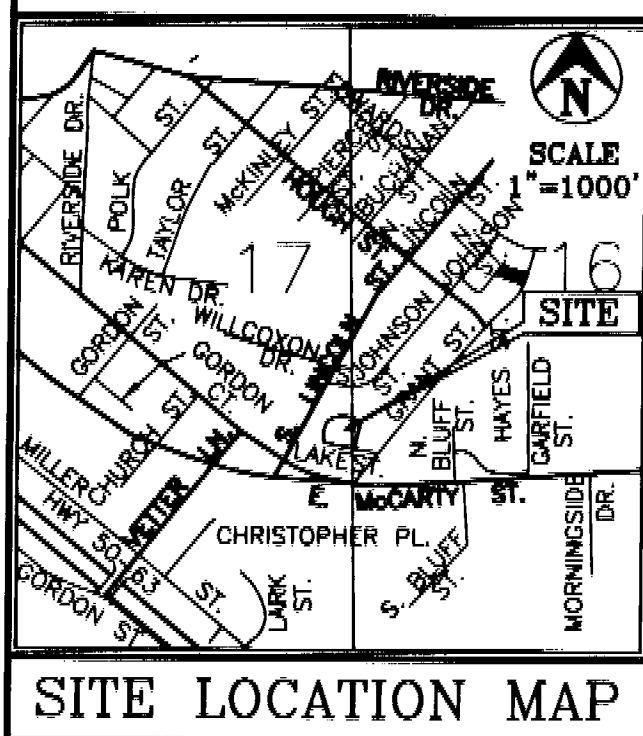

RECORD SOURCE DOCUMENTS:
Braun & Rackers, L.L.C.
Deed of record in Book 526, Page 228,
Cole County Recorder's Office.
Area = 22,152 Sq. Ft.

NOTE:
1.) Set 5/8" Rerod w/cap at all new lot corners, except as otherwise shown.
2.) In the boundary description of LINCOLN SUBDIVISION, as recorded in Plat Book 6, page 75-74, the centerline of Boggs Creek is called out as the boundary line. On the plat of RENNS ADDITION, as recorded in Plat Book 2, page 5, the statement is made that "where the creek or ravines form a boundary line to the addition, the Lots adjoining such boundary line extend to the center of said creek or ravine and may include more or less ground than is shown on this plat". Therefore, the centerline of the existing creek was used for the boundary of the lots shown on this Replat.

CURVE NUMBER	CHORD	RADIUS	ARC LENGTH
CURVE 1 (C-1)	Ch=N81°56'57"E, 64.82'	R=35.00'	L=82.87'
CURVE 2 (C-2)	Ch=N38°36'02"E, 29.07'	R=35.00'	L=29.91'
CURVE 3 (C-3)	Ch=S73°34'11"E, 48.05'	R=35.00'	L=52.96'

FLOODPLAIN NOTES:
1.) PART OF THIS TRACT MAY BE LOCATED IN ZONE X (500-YEAR FLOOD PLAIN) AS SHOWN BY THE FLOOD INSURANCE RATE MAP, CITY OF JEFFERSON CITY, MISSOURI, MAP NUMBER 29051C0134D, EFFECTIVE DATE DECEMBER 2, 2005 AND MAP NUMBER 29051C0142D, EFFECTIVE DATE DECEMBER 2, 2005. THE BASE FLOOD ELEVATION IS 555.
2.) THE CITY OF JEFFERSON'S COMPREHENSIVE STORMWATER MASTER PLAN UPDATE MODEL SHOWS THAT THE HIGHEST BASE FLOOD ELEVATION ON THESE LOTS IS 557.6. THE MINIMUM FINISHED FLOOR ELEVATION SHALL BE 558.6.

STATE OF MISSOURI } ss
COUNTY OF COLE }

Filed for record 11 day of August, 2006,
at 9 O'clock and 45 Minutes A.M., recorded in
Book 11, Page 544.

LARRY D. RADEMAN, Recorder

DEBRA NASH, Deputy

Document No. 200608910

I, the City Clerk of the City of Jefferson, County of Cole, State of Missouri, hereby certify that this plat was approved by the Mayor of the City of Jefferson, Missouri, by Ordinance No. 14032.

Approved this 17th day of April, 2006.

John Langwehr
John Langwehr, Mayor
Phyllis Powell
Phyllis Powell, City Clerk

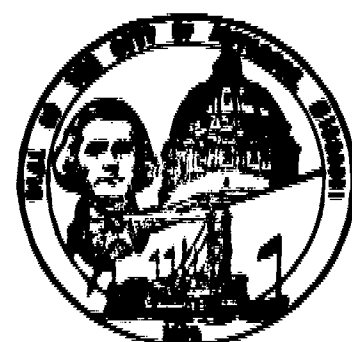

Central Missouri Professional Services, Inc.
ENGINEERING - SURVEYING
2500 E. McCARTY
JEFFERSON CITY, MISSOURI 65101
Phone (573) 634-3455
FAX (573) 634-8898

TITLE: REPLAT LOTS 14 & 15, RENNS ADDITION
LAKE STREET
FOR: CHAD RACKERS

DATE 12/22/2005
REV. DATE
DRN. BY J.B.R.
CHK. BY C.C.C., K.M.B.
SCALE 1" = 20'
SHEET 1 of 1
BOOK
JOB NO. 05-147

SUBD 477.00