

"STONEHILL" SECTION THREE

A REPLAT OF PART OF "MILLBROOK" TRACT "D","G","H" & "I" PB-8, PG-109 AND ALL THAT PART OF WEATHERED ROCK ROAD AND STONEHILL ROAD VACATED BY ORDINANCE NO. 12525 BK. 381, PG. 373 ZONING - PUD TOTAL AREA - 23.17 ACRES

PROPERTY DESCRIPTION

Parts of Tracts "D", "G", "H" and "I", "MILLBROOK", as per plat of record in Plat Book 8, page 108, Cole County Recorder's Office, and all that part of WEATHERED ROCK ROAD and STONEHILL ROAD as vacated by the City of Jefferson in Ordinance No. 12525, and recorded in Book 381, page 373, Cole County Recorder's Office, being part of the Southeast Quarter of Section 24, Township 44 North, Range 12 West, in the City of Jefferson, Missouri, more particularly described as follows:

From the Northwest corner of the Southeast Quarter of Section 24; thence S4°24'37"E, along the Quarter Section Line, 1471.58 feet to the southwest corner of "STONEHILL", SECTION TWO, as per plat of record in Plat Book 11, page 988, Cole County Recorder's Office and the point of beginning; thence S84°51'39"E, along the southerly line of "STONEHILL", SECTION TWO, 682.50 feet to a point on the westerly right-of-way line of STONEHILL ROAD; thence southeasterly, along the westerly right-of-way line of STONEHILL ROAD, on a curve to the right, having a radius of 358.64 feet, an arc distance of 58.17 feet, the chord of said curve being S38°34'28"E, 58.11 feet; thence S33°55'40"E, along the westerly right-of-way line of STONEHILL ROAD, 35.87 feet to a point on the northerly right-of-way line of WEATHERED ROCK ROAD; thence S14°17'51"E, leaving the northerly right-of-way line of WEATHERED ROCK ROAD, 60.00 feet to a point on the southerly right-of-way line of WEATHERED ROCK ROAD; thence northeasterly, along the southerly right-of-way line of WEATHERED ROCK ROAD, on a curve to the left, having a radius of 432.09 feet, an arc distance of 21.22 feet, the chord of said curve being N74°17'43"E, 21.22 feet to a point on the westerly line of STONEHILL ROAD; thence S33°55'40"E, along the westerly right-of-way line of STONEHILL ROAD, 366.33 feet; thence leaving the westerly right-of-way line of STONEHILL ROAD, N56°04'20"E, 60.00 feet to a point on the easterly right-of-way line of STONEHILL ROAD, also being the northerly corner of a tract of land deeded to the City of Jefferson for right-of-way as described in Book 385, page 98, Cole County Recorder's Office; thence southeasterly, along the westerly line of said tract, on a curve to the right, having a radius of 224.28 feet, an arc distance of 99.49 feet, the chord of said curve being S21°13'08"E, 99.68 feet to the southwesterly corner of said tract; thence N57°40'09"E, 204.65 feet to a point on the westerly right-of-way line of MISSOURI STATE ROUTE "B"; thence southeasterly, along the westerly right-of-way line of MISSOURI STATE ROUTE "B", on a curve to the right, having a radius of 654.58 feet, an arc distance of 400.66 feet, the chord of said curve being S29°03'34"E, 400.58 feet; thence S27°01'47"E, along the westerly right-of-way line of MISSOURI STATE ROUTE "B", 144.40 feet; thence S4°08'00"E, leaving the westerly right-of-way line of MISSOURI STATE ROUTE "B", 6.65 feet to a point on the Section Line; thence N4°24'37"W, along the Section Line, 1339.88 feet to the Quarter Section Line; thence N4°24'37"W, along the Quarter Section Line, 1256.32 feet to the point of beginning. Containing in all 23.17 acres.

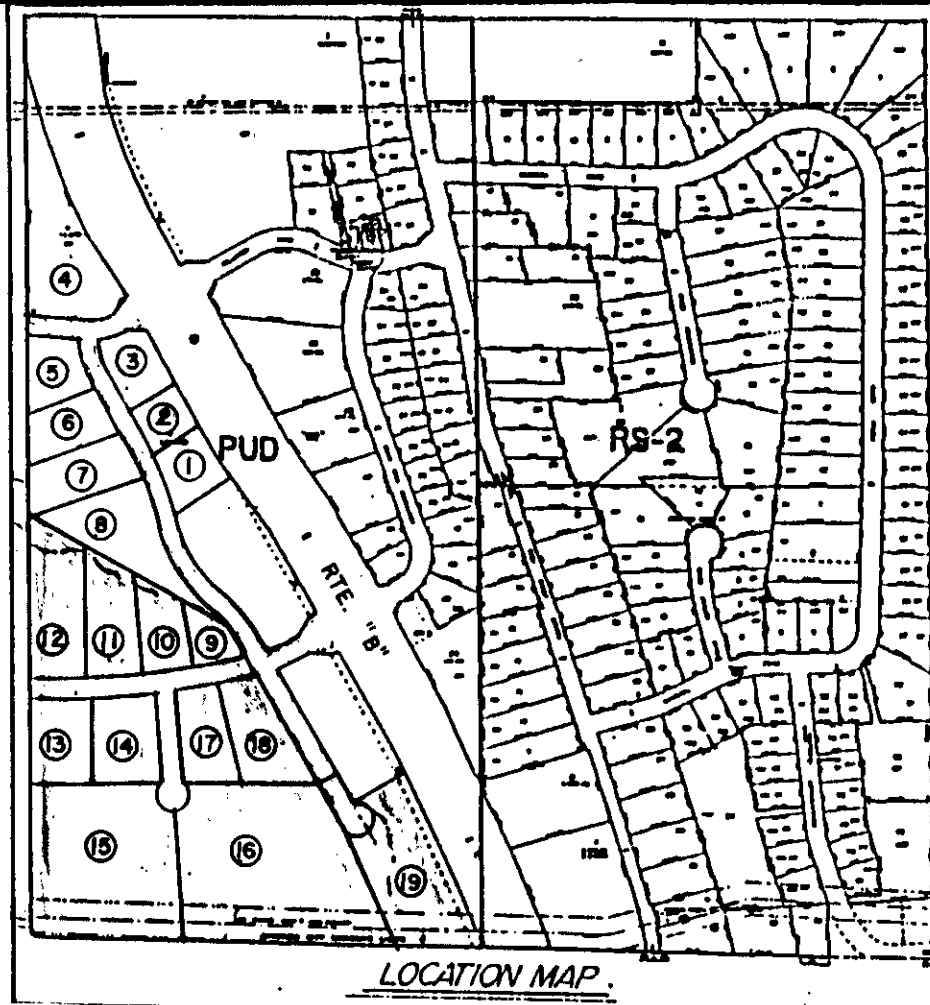

SURVEYOR'S CERTIFICATE

This is to certify that at the request of T.D.K. PROPERTIES, a survey was made under my personal direction regarding the above described property and that the results of said survey are represented correctly on this plat and that said survey was performed in accordance with the requirements of the standards for a property boundary survey as adopted by the Missouri Board for Architects, Professional Engineers and Land Surveyors.

In Witness whereof I have hereunto set my seal and signature this 12th day of Jan, 1998.

Larry V. Brickey
Larry V. Brickey, M.A. R.L.S. #1188

OWNERS CERTIFICATE

Know all men by these presents, that we, the undersigned, being the owners of the tract of land described in the foregoing property description, have caused said tract to be surveyed and subdivided into lots, and the sizes thereof are fully and truly set forth, and the undersigned do hereby dedicate to the public, for public use forever, all easements and rights-of-way (not presently of record), as shown on this plat, which shall be known as "STONEHILL" SECTION THREE. All taxes due and payable against said property have been paid in full.

In testimony whereof T.D.K. PROPERTIES, A Missouri General Partnership, the said party of the first part has caused these presents to be signed by its partners this 12 day of Jan, 1998.

T.D.K. PROPERTIES,
A Missouri General Partnership
Richard J. Otko
Richard J. Otko, Trustee
Richard J. Otko, Trust
U/A/D November 20, 1991
and his successors in Trust

Kenneth P. Otko
Kenneth P. Otko, Trustee
of the Kenneth P. Otko Revocable
Living Trust, U/A/D August 17, 1994
and his successors in Trust

STATE OF MISSOURI)
COUNTY OF COLE)

On this 12 day of Jan, 1998, before me personally did appear the above signed, to me personally known, who being by me duly sworn did say that they are the partners of T.D.K. PROPERTIES, A Missouri General Partnership, and that said instrument was signed in behalf of said General Partnership by authority of its partners, and said above acknowledges said instrument to be the free act and deed of said general partnership.

In Witness whereof, I have hereunto set my hand and affixed my seal this 12 day of Jan, 1998.

My commission expires: 12-30-99
Cance Cardwell
Cance Cardwell Notary Public

I, the City Clerk of the City of Jefferson, County of Cole, State of Missouri, hereby certify that this plat was approved by the Mayor of the City of Jefferson by Ordinance No. 12713.

Approved this 3rd day of FEBRUARY, 1998.

Duane E. Schreimann
Duane E. Schreimann, Mayor

Phyllis Powell
Phyllis Powell, City Clerk

Keith A. DeVault
Keith A. DeVault
Director of Planning & Code Enforcement

1/4 1/4 SECTION LINE



1 inch = 60 feet

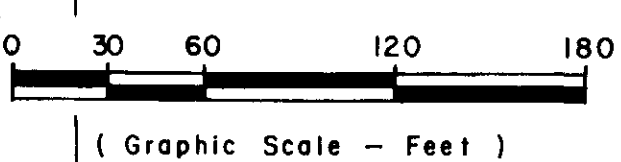

STATE OF MISSOURI)
COUNTY OF COLE)

Filed for record 11 day of February, 1998, at 10 o'clock and 26 Minutes
A. M., recorded in Book 12, Page 014.

Larry D. Rademan, Recorder

Deputy
Dale F. Rademan

COMPLETED

Document No. 1790

CENTRAL MISSOURI PROFESSIONAL SERVICES, INC.
ENGINEERING AND SURVEYING
TEST DRILLING
2500 EAST MC CARTY
JEFFERSON CITY, MISSOURI 65101

TITLE **STONEHILL SECTION THREE**
FOR **TDK PROPERTIES**

DATE 12-12-97	BOOK NO. 592, 626, 676, 706	SCALE 1" = 60'	DRN. BY JHH
REVISION DATE 1-2-97	CKD. BY L.V.B.	SHEET 1 OF 1	JOB NO. 73-197

NOTE: THIS PROPERTY IS WITHIN FLOOD HAZARD ZONE C AS INDICATED ON THE DEPARTMENT OF HOUSING AND URBAN DEVELOPMENT MAP FEDERAL INSURANCE ADMINISTRATION, DATED OCTOBER 6, 1981.

Set 1/2" Iron Pin w/cap at all Property Corners unless otherwise noted.

GERALDINE V. KARR
B 142, P 325

DAVID L. WILBERS
TRUSTEE
B 318, P 434
B 323, P 418