

STOCKSICK SUBDIVISION

RURAL DENSITY RESIDENTIAL
 PART OF THE NW 1/4, SW 1/4
 PART OF THE SW 1/4, NW 1/4
 SEC. 24, T45N, R14W
 COLE COUNTY, MISSOURI
 3.10 ACRES

PARENT TRACT
 RONALD C. & KEN P.
 STOCKSICK
 B-548, P-366
 REMAINING ACREAGE = 195.4 +/-

PROPERTY BOUNDARY DESCRIPTION

Part of the Southwest Quarter of the Northwest Quarter and part of the Northwest Quarter of the Southwest Quarter of Section 24, Township 45 North, Range 14 West, Cole County, Missouri, more particularly described as follows:

From a stone marking the northwest corner of the Northwest Quarter of the Southwest Quarter of said Section 24; thence N86°18'02"E, along the Quarter Section Line, 165.72 feet to the POINT OF BEGINNING for this description thence N7°00'20"E, 110.65 feet; thence N63°13'52"E, 201.41 feet; thence N85°26'10"E, 185.70 feet; thence S3°33'19"E, 190.44 feet to the Quarter Section Line; thence S86°18'02"W, along the Quarter Section Line, 156.80 feet to the northeasterly corner of a tract described by deed of record in Book 226, page 734, Cole County Recorder's Office; thence S5°16'15"E, along the easterly line of said tract, 218.98 feet to the southeasterly corner thereof, also being the northeasterly corner of a tract described by deed of record in Book 384, page 202, Cole County Recorder's Office; thence along the boundary of said tract described in Book 384, page 202 the following courses: S2°36'20"E, 47.80 feet; thence S84°24'00"W, 280.14 feet; thence N4°14'59"W, 58.04 feet; thence leaving the boundary of said tract described in Book 384, page 202, N7°00'20"E, 221.31 feet to the point of beginning. Containing 3.10 acres.

PRIVATE INGRESS / EGRESS EASEMENT

Part of the Northwest Quarter of the Southwest Quarter of Section 24, Township 45 North, Range 14 West, Cole County, Missouri, more particularly described as follows:

From a stone marking the northwest corner of the Northwest Quarter of the Southwest Quarter of said Section 24; thence N86°18'02"E, along the Quarter Section Line, 165.72 feet; thence S7°00'20"W, 111.81 feet to the POINT OF BEGINNING for this description; thence continuing S7°00'20"W, 110.00 feet; to the southerly line of a tract described by deed of record in Book 226, page 734, Cole County Recorder's Office; thence S86°29'45"W, along the southerly line of said tract, 33.51 feet; thence N7°00'20"E, 82.00 feet; thence N51°00'50"E, 47.42 feet to the point of beginning.

OWNER'S CERTIFICATE

Know all men by these presents, that we, the undersigned, being the owners of the tract of land described in the foregoing property description, have caused said tract to be surveyed and subdivided into a lot and the size thereof is fully and truly set forth. This plat shall be known as STOCKSICK SUBDIVISION.

All taxes due and payable against said property have been paid in

In Witness whereof, the undersigned owners of said tract have hereunto set their hands this ____ day of May, 2010.

Ronald C. Stocksick
 Ronald C. Stocksick
Kenneth P. Stocksick
 Kenneth P. Stocksick

State of Missouri }
 County of Cole } ss

On this 15 day of May, 2010, before me did personally appear the above signed property owners, who executed the foregoing instrument and acknowledged the same to be their free act and deed.

In Witness whereof, I have hereunto set my hand and affixed my seal this 15 day of May, 2010.

My Commission Expires: 03-24-12

Jessica Jackson
 Notary Public, Cole County

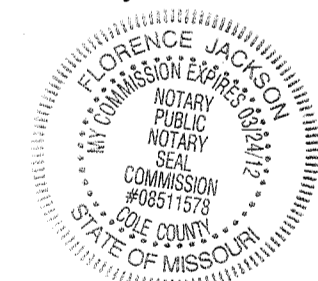

We, the undersigned of the Cole County Planning Commission, do hereby certify that this plat was approved on the 11 day of May, 2010.

Duane Amos
 Duane Amos - Chairman
Larry J. Benz
 Larry J. Benz, P.E., Director

Central Missouri Professional Services, Inc.
 ENGINEERING - SURVEYING - MATERIALS TESTING
 2500 E. McCARTY Phone (573) 634-3455
 JEFFERSON CITY, MISSOURI 65101 FAX (573) 634-8898

TITLE **STOCKSICK SUBDIVISION**
PT. W 1/2, SEC. 24, T45N, R14W

FOR **RON AND KEN STOCKSICK**

DATE	APR. 12, 2010	DRN. BY	K.B.	SCALE	1" = 100'	BOOK
REV. DATE		CKD. BY		SHEET	1 OF 1	JOB NO. 88-162

SE 1/4, NE 1/4
 SEC. 24, T45N, R14W

FD STONE
 NW CORNER
 NW 1/4, SW 1/4
 SEC. 24, T45N, R14W

RONALD C. & KEN P.
 STOCKSICK
 B-548, P-366

NE 1/4, SE 1/4
 SEC. 23, T45N, R14W

BARRY M. & JANICE M.
 GENTILE
 B-310, p-708

LOT 4
 FREDDI-JEAN SUBD.
 PB-11, P-912

DENNIS P. & PATRICIA A.
 WOLF
 B-538, P-60

LOT 1
 3.10 AC.
 (11925)

SW 1/4, NW 1/4
 SEC. 24, T45N, R14W

DENNIS P. & PATRICIA A.
 WOLF
 B-391, P-657

LOT 6
 FREDDI-JEAN SUBD.
 PB-11, P-912

RESERVED TRACT A

LOT 3

NW 1/4, SW 1/4
 SEC. 24, T45N, R14W

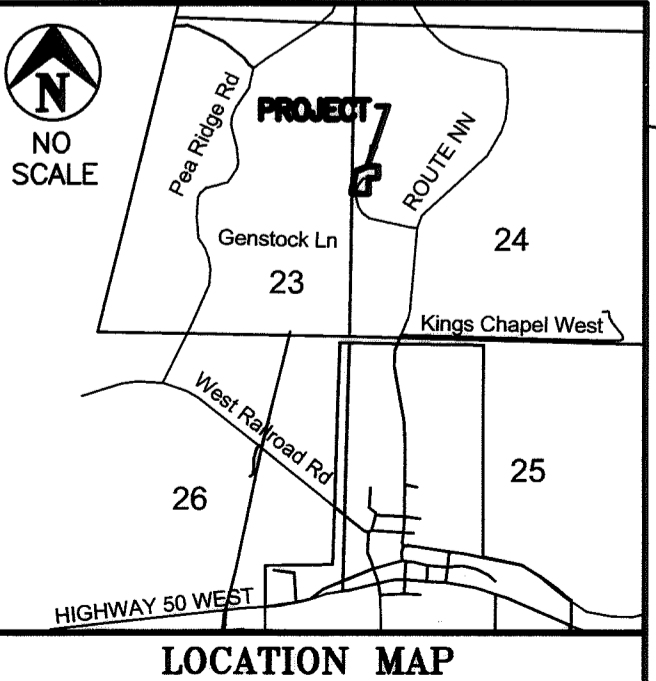

NOTES:

- LAND USE - Rural Density Residential
- SEWER - Individual
- ELECTRIC - Three Rivers Electric
- WATER - Private

SET 1/2" IRON ROD W/CAP AT ALL LOT CORNERS UNLESS OTHERWISE SHOWN

● = FOUND IRON ROD

BUILDING LIMIT LINES (FROM PROPERTY LINE)

FRONT = 25 FEET
 SIDE AND REAR = 10 FEET

THE LOT IN THIS SUBDIVISION CONFORMS TO THE REQUIREMENTS FOR LAND DEVELOPEMENT OF COLE COUNTY AS SET FORTH BY THE SUBDIVISION DESIGN AND IMPROVEMENTS STANDARDS IN THE RULES FOR LAND SUBDIVISION OF COLE COUNTY AND AMENDMENTS THERETO.

THIS PROPERTY IS IN ZONE "X", (AREA OUTSIDE OF 0.2% ANNUAL FLOOD CHANGE) AS SHOWN BY FEMA'S FLOOD INSURANCE RATE MAP, COUNTY OF COLE, MISSOURI COMMUNITY PANEL NUMBER 29051C0025D, EFFECTIVE DATE, DECEMBER 2, 2005.

SURVEYOR'S CERTIFICATE

This is to certify that at the request of Ron Stocksick, a survey and subdivision was made under my personal direction, regarding the property shown on this plat and that the results of said survey are represented correctly. This survey was performed in accordance with the current Missouri Minimum Standards for a Suburban Property Boundary Survey.

In Witness whereof I have hereunto set my seal and signature this 13th day of May, 2010.



Keith M. Brickey, Mo. PLS #2578

COPY

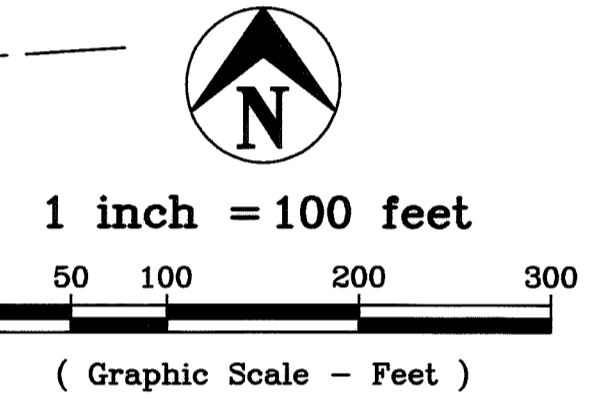

BEARING BASE: SOUTH LINE, DEED OF RECORD IN BOOK 384, P-202, COLE COUNTY RECORDER'S OFFICE.

Document No. 201004425

STATE OF MISSOURI }
 COUNTY OF COLE } ss

Filed for record 26 day of May, 2010.

at 10 O'clock and 31:47 Minutes A. M.,
 recorded in Book 12, Page 692.

LARRY D. RADEMAN, Recorder

Deputy

CCPW
 50258