

OWNERS CERTIFICATE

Know all men by these presents that we, the undersigned, being the owners of the tract of land described in the foregoing Surveyors Certificate, hereby certify that we have paid all taxes due and payable against said property that on the annexed plat the numbers of the lots and the sizes thereof, are fully and truly set forth, and we do hereby dedicate to the City of Jefferson, a Municipal Corporation, for public use forever all Streets and Easements as shown on this plat.

In witness whereof we have hereunto set our hands and seals this 22 day of February, 1973

Joseph P. ...

State of Missouri s.s.
County of Cole

On this 22 day of February, 1973, before me personally appeared the above signed property owners who executed the foregoing instrument and acknowledge the same to be their free act and deed.

In witness whereof I have hereunto set my hand and affixed my seal this 22 day of Feb, 1973.

Joseph P. ...
Notary Public
Cole County

My Commission expires Jan 30, 1977

I, the City Clerk of the City of Jefferson, County of Cole, State of Missouri, hereby certify that this plat was approved by the Mayor of the City of Jefferson, Missouri by Ordinance Number 7 Approved this 22 day of February, 1973.

Mayor _____ City Clerk _____
Planning and Zoning Commission, Zone District #54 _____ Director of Public Works _____

SURVEYORS CERTIFICATE

I, L.V. Prickey do hereby certify that during the month of December, 1972, I did make a survey regarding Lot Nos. 9, 10, 15, and 16, of Weavers Subdivision, as per plat of record in Book 7, Page 77, Cole County Recorder's Office, and part of Outlot No. 73, in the City of Jefferson, County of Cole, Missouri, more particularly described as follows:

Beginning at the Northeast Corner of said Lot 14; thence N 55° 28' W, along the Northerly line of said Lot 14, 147.75 feet to the Northwest Corner thereof; thence N 35° 00' E, along the Westerly line of Lot Nos. 15 and 16, and the Northerly extension thereof, 132.8 feet; thence S 55° 23' E, 19 feet; thence N 90° 00' E, 39.0 feet; thence N 75° 50' E, 32.0 feet; thence N 60° 17' E, 38.0 feet; thence S 80° 27' E, 48.0 feet; thence S 65° 26' E, 10.0 feet; thence S 50° 20' E, 154.12 feet; thence S 35° 00' W, 56.0 feet; thence S 55° 28' E, 133.50 feet; thence S 35° 00' W, along the Northerly extension of and the Easterly line of Lot Nos. 10 and 9, 171.70 feet; thence N 55° 28' W, 7.5 feet; thence S 35° 00' W, 8.30 feet to the Southeast corner of said Lot No. 9; thence N 55° 28' W, along the Southerly line of said Lot No. 9, 218.0 feet to the Southwest Corner thereof; thence S 35° 00' W, along the Westerly line of Lot No. 8, of said Weavers Subdivision 7.08 feet; thence N 55° 28' W, 60.0 feet to the point of beginning. Bearings are magnetic.

Re-plot of Lot Nos. 9, 10, 15 & 16 of Weavers Subdivision and part of Outlot No. 73 in the City of Jefferson, Missouri

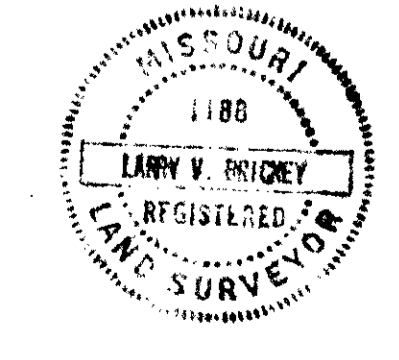

L.V. Prickey
Surveyor No. 1188

CENTRAL MO. PROFESSIONAL SERVICES INC. PROFESSIONAL ENGINEERS - SURVEYORS		
JEFFERSON CITY	MISSOURI	
JOE MEAVER Jefferson City, Missouri		
SCALE 1"=20'	DATE 12-72	72-191 B-61

SUB 194.00